

# TLS - TRUNKING LIGHT SYSTEM

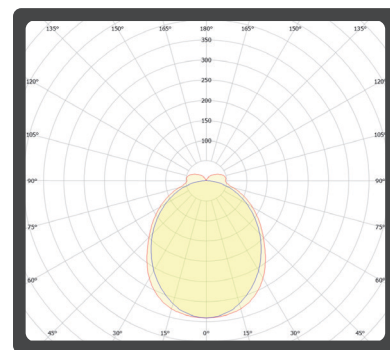

	L	H	B
TLS 1L 50%	1138	70	58
TLS 1L 100%	1138	70	58
TLS 2L 50%	2276	70	58
TLS 2L 100%	2276	70	58
COVERS 1L	1138		
COVER 2L	2276		
COVER 3L	3414		
COVER 4L	4552		
RAIL 3L	3414		
RAIL 4L	4552		

## Standard

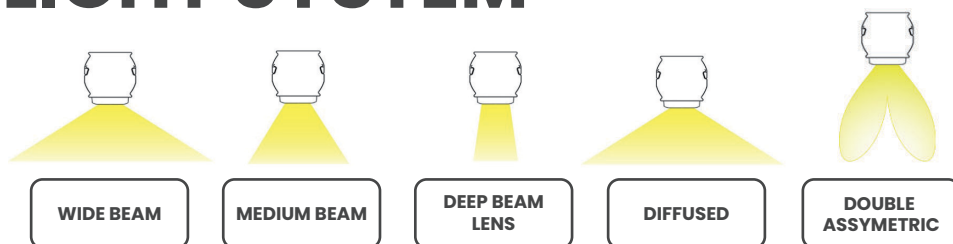

## Opțiuni

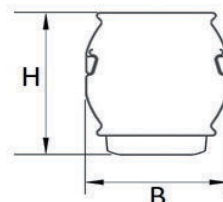

## Accesorii



START - END KIT



HANGING ELEMENTS

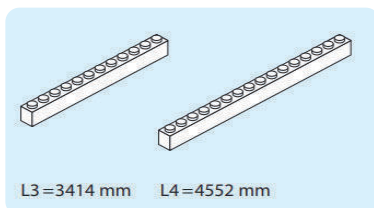

RAILS

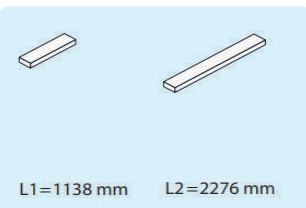

COVERS



SENSOR UNITS



L1 50% LIGHT  
3500LM  
1138MM

L2 100% LIGHT  
7000LM  
1138MM

L2 50% LIGHT  
7000LM  
2276MM

L2 100% LIGHT  
14000LM  
2276MM

TIP	CRI	CCT	SRC	Flux (lm)	Putere totală (W)	Eficacitate lm/W	Ta
TLS 1L 50% 3500LM	80	4000	1	3500	21.0	167	+10°C / +40°C
TLS 1L 100% 7000LM	80	4000	2	7000	41.0	171	+10°C / +40°C
TLS 1L 100% 10000LM	80	4000	2	10000	54.0	185	+10°C / +40°C
TLS 2L 50% 7000LM	80	4000	2	7000	40.0	175	+10°C / +40°C
TLS 2L 100% 14000LM	80	4000	4	14000	75.0	187	+10°C / +40°C
TLS 2L 100% 20000LM	80	4000	4	20000	114.0	175	+10°C / +40°C